

## Fitting guide for AirFit N10



- Ensure the grey side of the headgear that shows the ResMed and AirFit N10 logos is facing outwards.
- Disconnect lower straps. Line up the bottom of the cushion with the bottom of the nose.



- Place the cushion over the nose.
- Hold the mask against the face.
- Pull the headgear up and over the head.



- Bring the lower straps below the ears and attach the EasyClick clips to the outside of the frame.



- Undo the upper fastening tabs.
- Adjust the straps evenly until the mask sits comfortably just under the nose and then reattach the fastening tabs so that they align with the upper straps.

**TIP:** The upper straps are the key adjustments for seal and comfort. Ensure they are not over-tightened.



- Undo the fastening tabs on the lower straps. Adjust both of the straps evenly until the mask is stable then reattach tabs.
- Connect the mask tubing to the air tubing attached to the device.

**TIP:** The lower straps require only minimal tension for the mask to fit comfortably.



- Turn on the device so it blows air.
- Adjust the cushion and headgear until the mask sits comfortably on the nose and is not creased or twisted.
- The mask is now ready to use.

**Note:** For complete user instructions refer to the user guide.



### Additional options

- Patients can position the lower part of the headgear over or under their hair to suit their hairstyle preference.
- Optional soft sleeves may be assembled for enhanced comfort on the cheeks.

## AirFit™ N10 sizing and fitting tips

ResMed's AirFit N10 compact nasal mask is designed to deliver effortless performance with simplicity and comfort. It offers patients a uniquely light and comfortable seal, plus an open field of vision thanks to its under-eye frame.



## Sizing AirFit N10

We recommend that you refer to the mask fitting template to gauge which size is the most suitable for each of your patients.

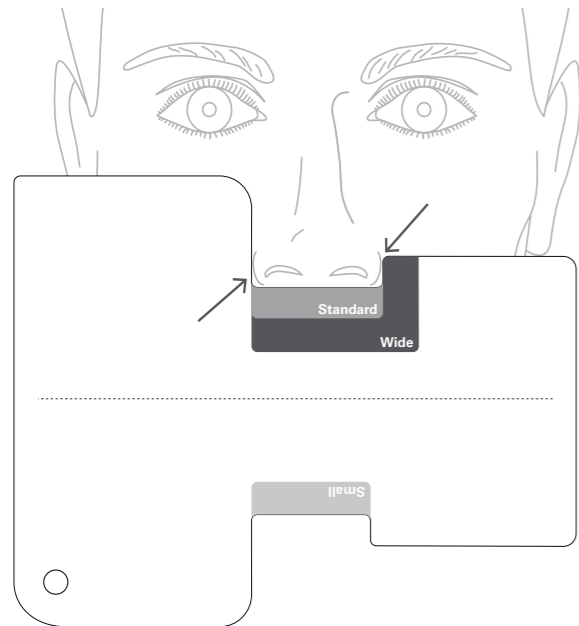

## Three cushion sizes

AirFit N10 is available in three cushion sizes: Small, Standard and Wide.



The Standard size cushion accommodates most male patients, yet some may find the Small or Wide size cushion provides a more optimal fit. The Small size cushion provides a good fit for most female patients.

## Position the cushion

AirFit N10's cushion sits lower on the nose than Mirage™ FX.

This improves the patient's line of sight and shifts the sealing area further away from the eyes. AirFit N10's cushion should sit with its weight evenly distributed around the patient's nose.

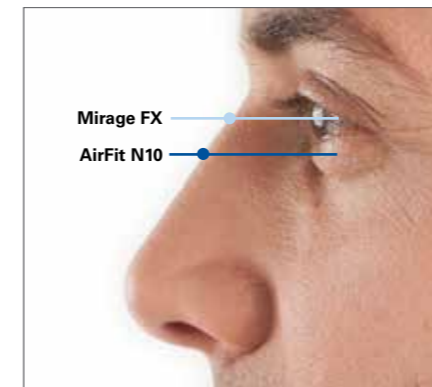

## Position the headgear

AirFit N10 is available in two headgear sizes – Standard and Small. No matter which size is selected, AirFit N10's headgear neck piece should be positioned to sit at the top of the neck.

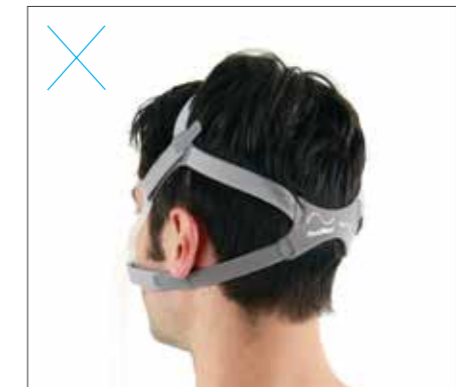

## Achieve an optimal seal

AirFit N10's cushion seals through inflation. **Be careful not to over-tighten** when adjusting the headgear straps.



- The upper straps are the primary adjustments for seal and comfort. They're designed for a secure fit without having to be fixed tightly in place.

- The lower straps provide secondary support and stability and only require very minimal tension.

## Adjustment tips

If a light and comfortable seal is not immediately achieved, the patient can follow the four easy steps below.



1. With the mask on and air flowing, loosen the lower straps as much as possible, then loosen the upper straps. Reposition the cushion if necessary.
2. Ensure the headgear is positioned with the neck piece sitting at the top of the neck.
3. Lightly adjust the upper straps only until leak stops at the nasal bridge.
4. Then lightly adjust the lower straps as required to achieve a gentle and stable seal.